

## EMERGENCY WIDE AREA SIREN



The Emergency Wide Area Siren is a single ended hazard-warning siren designed to give effective warning over a wide area.

The unit has the typical air raid siren sound, the low frequency giving excellent sound coverage.

The siren is manufactured from cast aluminium ensuring a long life when mounted outside. It is designed for roof, pole, tower or plinth mounting.

The siren is powered by a 2.2kW motor and is continuously rated.

### Features

- Powerful sound output for wide area coverage of up to 4 kilometers in still air
- Universally recognised emergency sound
- Single phase or 3 phase motor
- Rugged construction for outdoor use

### Applications

- Disaster and emergency warning
- Security alarm
- Rural fire alarm
- Flood warning
- General alarm
- Public warning (Evacuation)

### Specifications

Audibility	: 130dB $\pm$ 3dB at 1m
Range	: Approximately 4km in still air
Motor Power	: 2.2kW
Voltage	: Single phase 230Vac or 3 phase 400Vac options
IP Rating	: IP55
Rating	: Continuous
Frequency	: 500Hz $\pm$ 5hz
Construction	: Cast aluminium
Finish	: Gray Enamel Body / Red Impeller
Dimensions	
- single phase	: length 550mm, width 395mm, height 410mm
- three phase	: length 500mm, width 395mm, height 405mm
Approx. Weight	: 45kg
Mounting	: Horizontally on Pole, Tower or Roof

### CARREL ELECTRADE LTD

MANUFACTURERS, IMPORTERS AND DISTRIBUTORS OF ELECTRICAL ENGINEERING PRODUCTS  
 POSTAL ADDRESS: P O BOX 11078, ELLERSLIE 1542, AUCKLAND NEW ZEALAND  
 FACTORY AND OFFICE: 661 GREAT SOUTH ROAD, PENROSE 1061  
 TELEPHONE: +64-9-525 1753 FACSIMILE: +64-9-525 1756  
 CHRISTCHURCH BRANCH: 73B BRISBANE STREET, SYDENHAM  
 TELEPHONE: 03-366 1242 FACSIMILE: 03-379 1991  
 EMAIL: sales@carrel-electrade.co.nz WEB: www.carrel-electrade.co.nz

**Dimensions**  
- 3 Phase motor

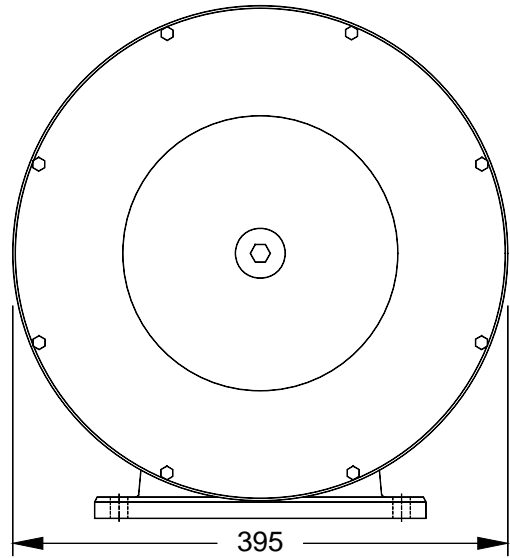
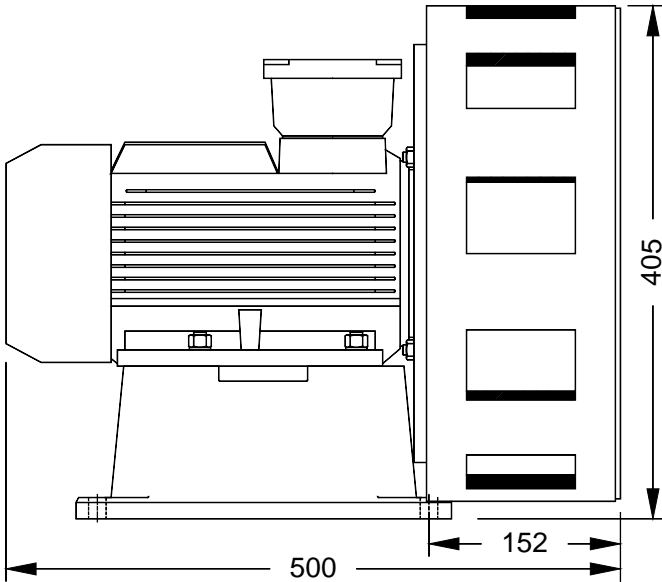

**Base dimensions**

